

Golf

Current Flow Diagram

No. 110 / 1

Edition 05.2006

Multifunction steering wheel

from May 2005

Notes:

For information concerning

- ◆ Position of relays and fuses
- ◆ Multi-pin connections
- ◆ Control units and relays
- ◆ Earth points

→ List of Fitting Locations!

For information concerning

- ◆ Fault Finding Programs

→ guided fault finding

Golf

Current Flow Diagram

No. 110 / 2

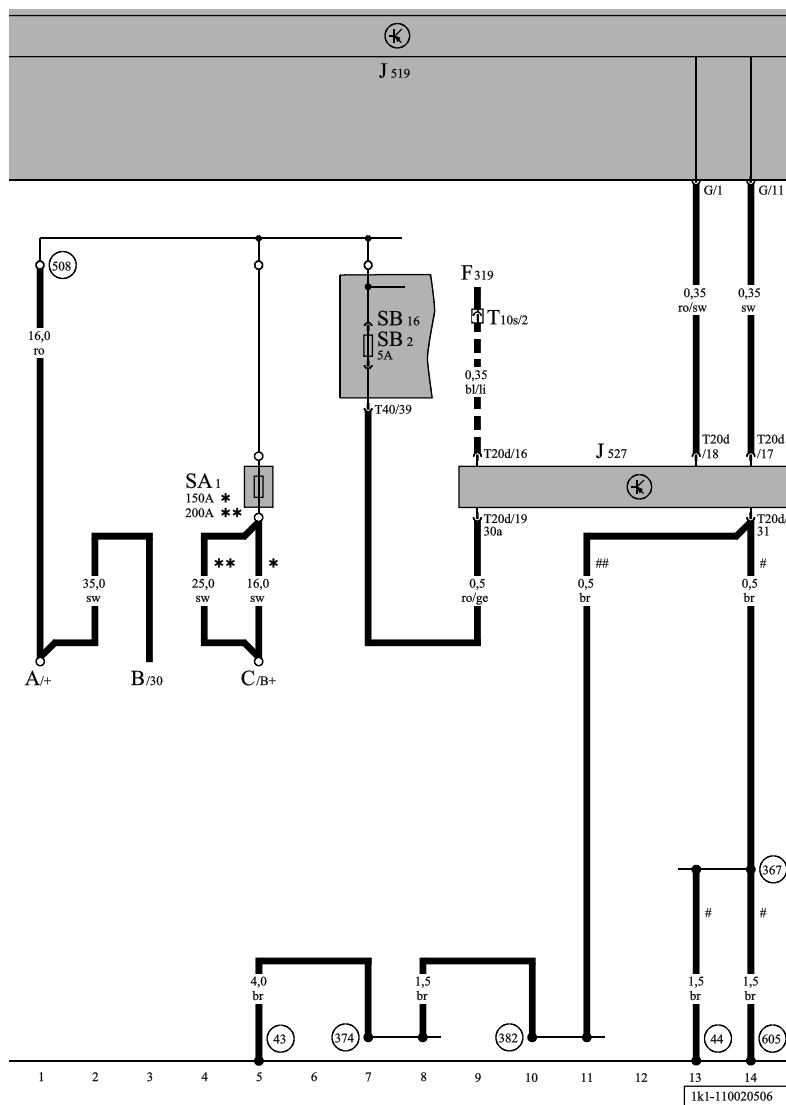

Steering column electronics control unit

- A - Battery
- B - Starter
- C - Alternator
- F319 - Selector lever locked in position P switch
- J519 - Onboard supply control unit
- J527 - Steering column electronics control unit
- SA1 - Fuse 1 on fuse holder A
- SB2 - Fuse 2 on fuse holder B
- SB16 - Fuse 16 on fuse holder B, electronics box high
- T10s - 10-pin connector, under selector lever cover
- T20d - 20-pin connector
- 43 - Earth point, lower part of right A-pillar
- 44 - Earth point, lower part of left A-pillar
- 367 - Earth connection 2, in main wiring harness
- 374 - Earth connection 9, in main wiring harness
- 382 - Earth connection 17, in main wiring harness
- 508 - Screw connection (30), on electronics box
- 605 - Earth point, on top end of steering column
- * - Models with 90 A/ 120 A alternator
- ** - models with 140 A alternator
- - models with 6-speed automatic gearbox 09G/ double clutch gearbox 02E only (DSG)
- # - USA/ Canada from October 2005, not for USA/ Canada from May 2006
- ## - not for USA/ Canada up to April 2006

ws = white
 sw = black
 ro = red
 rt = red
 br = brown
 gn = green
 bl = blue
 gr = grey
 li = purple
 vi = purple
 ge = yellow
 or = orange
 rs = pink

1kl-110020506

Golf

Current Flow Diagram

No. 110 / 3

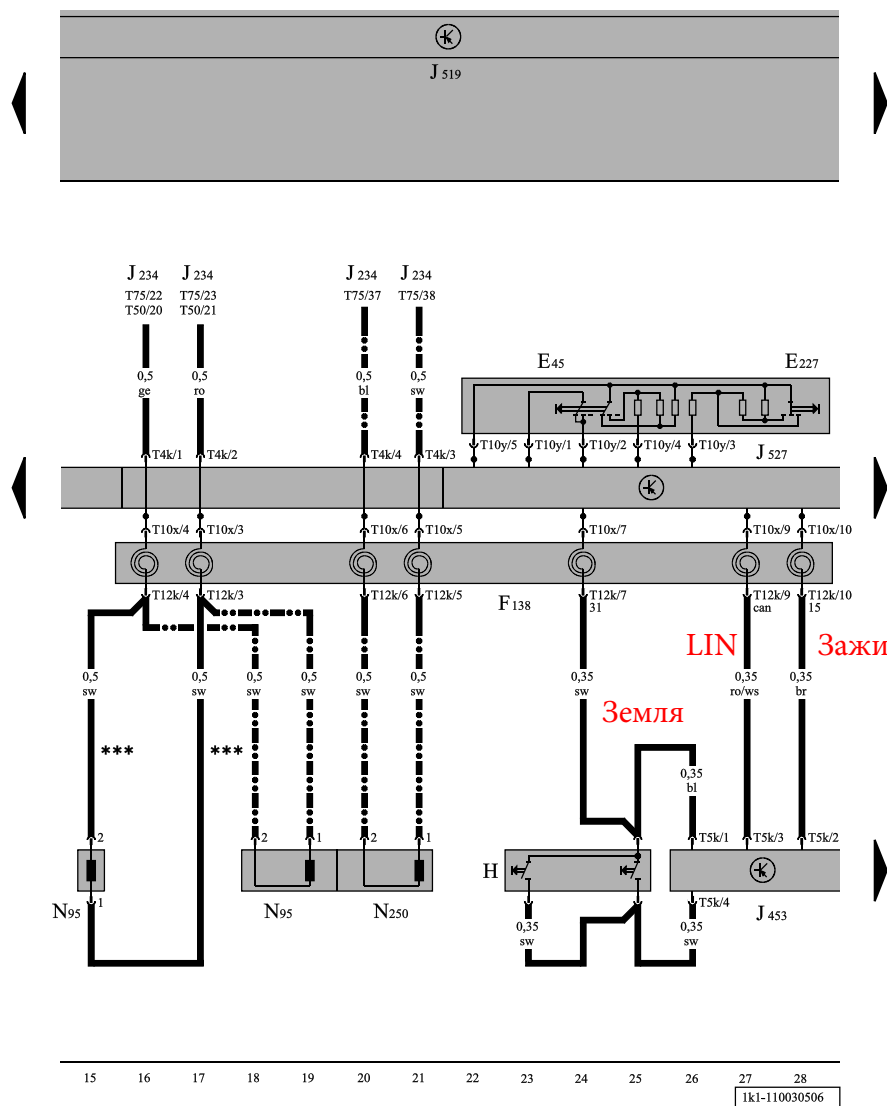

Steering column electronics control unit, multifunction steering wheel control unit, cruise control system switch, driver side airbag igniter, horn plate

- E45 - Cruise control system switch
- E227 - Cruise control system button
- F138 - Airbag coil connector
- H - Horn plate
- J234 - Airbag control unit
- J453 - Multifunction steering wheel control unit, in steering wheel
- J519 - Onboard supply control unit
- J527 - Steering column electronics control unit
- N95 - Driver side airbag igniter
- N250 - Driver side airbag igniter 2
- T4k - 4-pin connector
- T5k - 5-pin connector
- T10x - 10-pin connector
- T10y - 10-pin connector
- T12k - 12-pin connector
- T50 - 50-pin connector
- T75 - 75-pin connector
- *** - not for USA/ Canada
- - only USA/ Canada

ws = white
 sw = black
 ro = red
 rt = red
 br = brown
 gn = green
 bl = blue
 gr = grey
 li = purple
 vi = purple
 ge = yellow
 or = orange
 rs = pink

Golf

Current Flow Diagram

No. 110 / 4

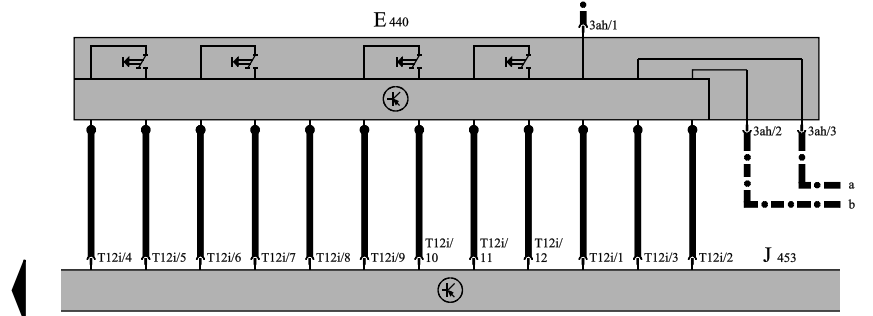
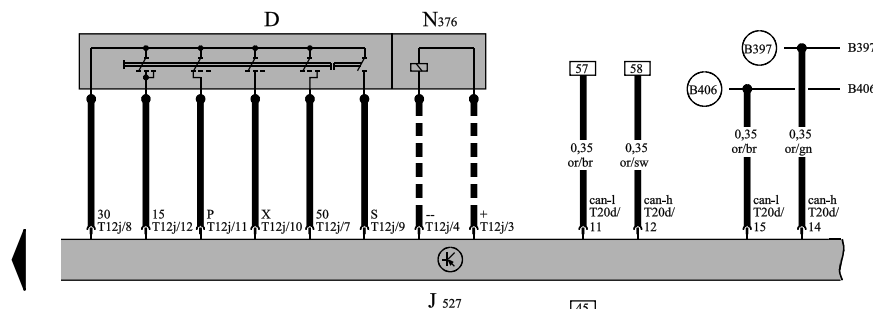
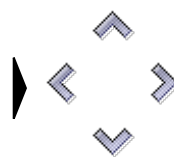
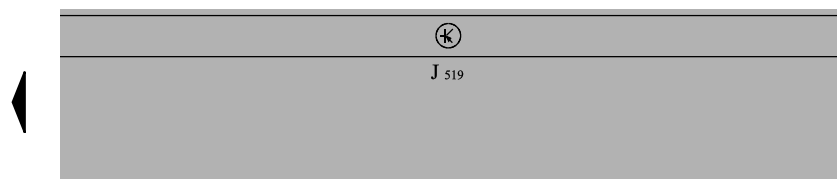

- ws = white
- sw = black
- ro = red
- rt = red
- br = brown
- gn = green
- bl = blue
- gr = grey
- li = purple
- vi = purple
- ge = yellow
- or = orange
- rs = pink

Steering column electronics control unit, multifunction steering wheel control unit, ignition/starter switch, multifunction buttons on left in steering wheel

- D - Ignition/starter switch
- E440 - Multifunction buttons on left in steering wheel
- J453 - Multifunction steering wheel control unit, in steering wheel
- J519 - Onboard supply control unit
- J527 - Steering column electronics control unit
- N376 - Ignition key withdrawal lock solenoid
- T3ah - 3-pin connector
- T12i - 12-pin connector
- T12j - 12-pin connector
- T20d - 20-pin connector
- B397 - Connection 1 (convenience CAN bus, high), in main wiring harness
- B406 - Connection 1 (convenience CAN bus, low), in main wiring harness
- - models with 6-speed automatic gearbox 09G/ double clutch gearbox 02E only (DSG)
- - only models with Tiptronic from November 2003

Golf

Current Flow Diagram

No. 110 / 5

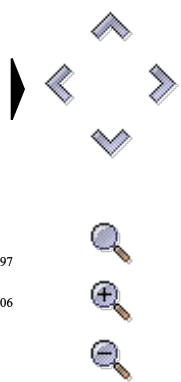
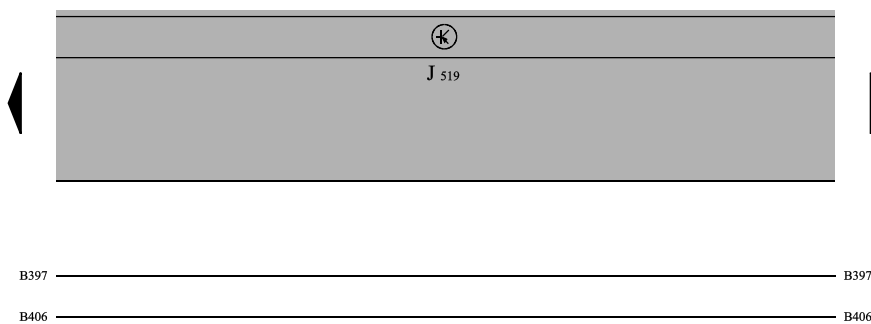

Multifunction steering wheel control unit, multifunction buttons on right in steering wheel, Tiptronic switch in steering wheel

- E438 - Tiptronic switch in steering wheel to shift up
- E439 - Tiptronic switch in steering wheel to shift down
- E441 - Multifunction buttons on right in steering wheel
- J453 - Multifunction steering wheel control unit, in steering wheel
- J519 - Onboard supply control unit
- T3ai - 3-pin connector
- T10y - 10-pin connector
- - only models with Tiptronic

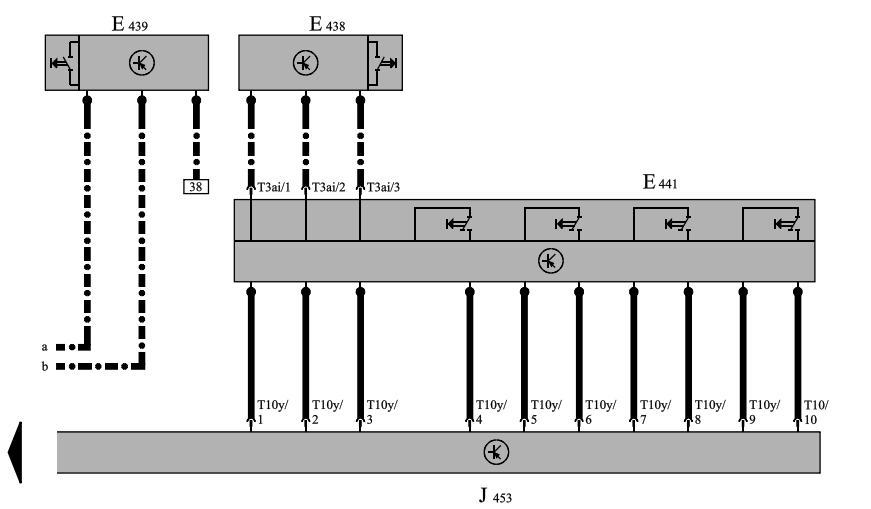

- ws = white
- sw = black
- ro = red
- rt = red
- br = brown
- gn = green
- bl = blue
- gr = grey
- li = purple
- vi = purple
- ge = yellow
- or = orange
- rs = pink

Golf

Current Flow Diagram

No. 110 / 6

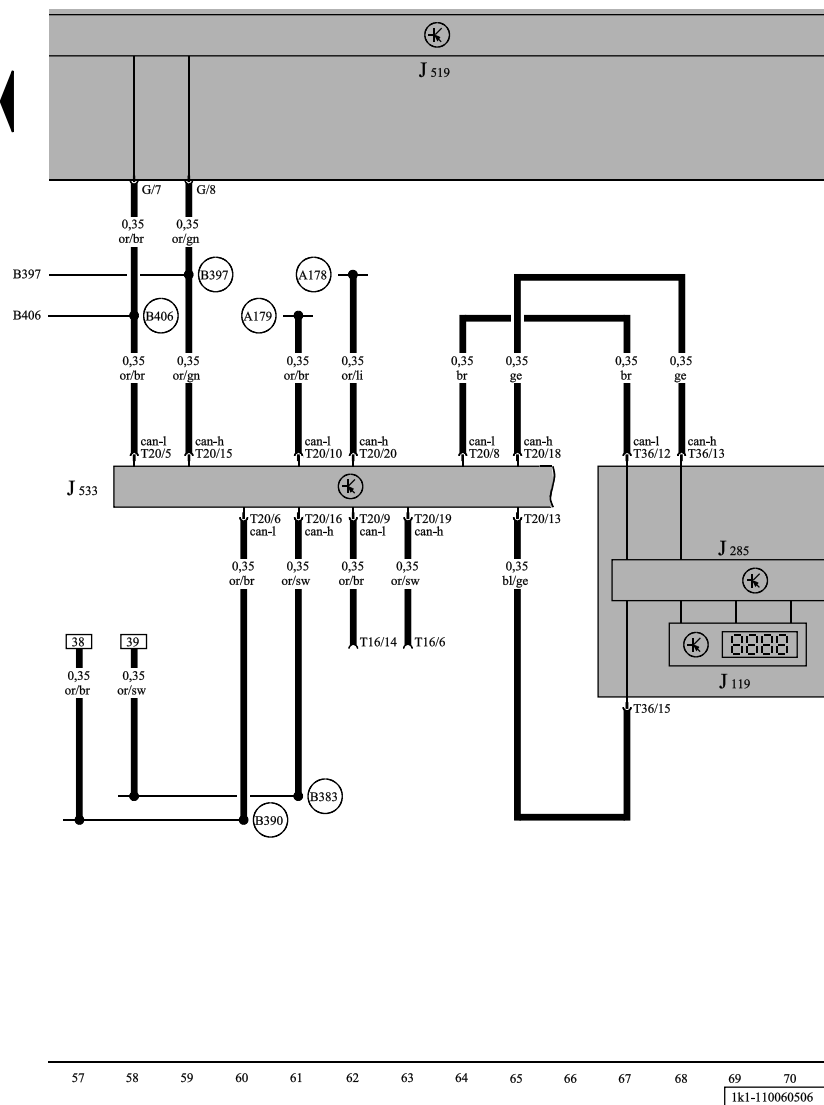

Dash panel insert, data bus diagnostic interface, multifunction display, self-diagnosis connection

- J119 - Multifunction display
- J285 - Control unit in dash panel insert
- J519 - Onboard supply control unit
- J533 - Data bus diagnostic interface, in left footwell, near centre console
- T16 - 16-pin connector, on left under dash panel, self-diagnosis connection
- T20 - 20-pin connector
- T36 - 36-pin connector
- A178 - Connection (infotainment CAN bus, high), in dash panel wiring harness
- A179 - Connection (infotainment CAN bus, low), in dash panel wiring harness
- B383 - Connection 1 (drive train CAN bus, high), in main wiring harness
- B390 - Connection 1 (drive train CAN bus, low), in main wiring harness
- B397 - Connection 1 (convenience CAN bus, high), in main wiring harness
- B406 - Connection 1 (convenience CAN bus, low), in main wiring harness



ws = white
 sw = black
 ro = red
 rt = red
 br = brown
 gn = green
 bl = blue
 gr = grey
 li = purple
 vi = purple
 ge = yellow
 or = orange
 rs = pink